

12V BMW 6 GT



Specification are subject to change without notice.

- Suitable for ages 3~5 years
- Maximum user weight: 55lb(25kg)
- Adult assembly required

OWNER'S MANUAL with Assembly Instructions

Read and understand this entire manual before using!

Please keep this manual for future reference as it contains important information.

Table of Contents

1. About Your New Ride-On Toy
2. Introduction, Safety and Warnings.
3. Parts List
4. Parts Diagram
5. Assembly Steps
6. How To Operate Your Ride-On Toy
7. Charging Your Ride-On Toy
8. Troubleshooting Guide
9. Maintaining Your Ride-On Toy
10. Battery Care And Disposal

About Your New Ride-on Toy

Thank you for your purchasing our products, we wants your child to enjoy this product for years to come. Keep these below information in mind as you read this guide:

Suitable Age:	3~5 years	Battery:	12V4AH(6V4AH *2)
Load Capacity:	Under 55lb (25kg)	Size of Car:	106*64*51 CM
Max Speed:	Low 2.0MPH / High 3.0MPH	Power Way:	Charging Type
Charger:	Input: AC 120V/ 60HZ Output: DC 12V0.5A	Average Battery Life:	Approximately 300 charges ★
Charge Time:	12-18 Hours	Fuse:	25A & 3A

★ This is an estimate only, not a guarantee. Actual battery performance will vary based on many factors, including but not limited to maintenance, charging habits, operation of product, and temperature.



WARNING!

- **ADULT ASSEMBLY REQUIRED.** The product contains small parts, which are for adult assembly only. Keep small children away when assembling.
- Always remove protective material and poly bags and dispose before assembly.

**FOR THE SAFETY OF YOUR CHILD, PLEASE READ ALL WARNINGS AND ASSEMBLY-
/USE INSTRUCTIONS. KEEP THIS GUIDE FOR FUTURE REFERENCE.**

Introduction, Safety and Warnings:

ABOUT THIS MANUAL: This Manual was written to help you and your child get the most performance, comfort, enjoyment and safety when riding your new electric ride-on toy. It is important for you to understand your new electric ride-on toy. By reading this manual before you let your child go out on his/her first ride, you will know how to get the most from your new electric ride-on toy. It is also important that you or your child's first ride be in a controlled environment, away from cars, obstacles, and other riders.

 **WARNING:** To reduce risk of injury, adult supervision is required. Never use in roadways, near motor vehicles, on or near steep inclines or steps, swimming pools or other bodies of water; always wear shoes, and never allow more than one (1) rider.

 **WARNING:** Do not ride in rain, snow, or mud, or store the ride-on toy outside without covering. Water can damage components, including the motor, electrical system, and battery.

 **WARNING:** CHOKING HAZARD. Adult assembly required. Small children can be harmed by small parts, sharp edges and sharp points in the product's unassembled state.

 **WARNING:** This ride-on toy is not an off-road vehicle and is intended to be ridden on smooth, level ground. Do not ride in loose dirt, sand, or gravel, which could damage moving parts, the motor, or the electrical system.

NOTE: Store the ride-on toy indoors when not in use or in a covered location. Avoid long term exposure to rain, excessive sun, or other inclement weather.

ALWAYS USE PROPER RIDING ATTIRE. Always wear appropriate clothing and shoes. Never ride barefoot or in sandals and make sure that shoelaces or other fasteners are tied and kept away from the wheels and drive system of the ride-on toy.

RIDER USE AND REQUIRED PARENTAL SUPERVISION

RIDERS MUST NOT EXCEED THE WEIGHT LIMIT OF 55 LB (25 KG) AND MUST BE OVER 3 YEARS OLD.

- Children operating the electric ride-on toy should be supervised by an adult at all times. Parents should ensure that children only use the electric ride-on toy safely and within their age and physical limits.
- Always stay seated while riding the electric ride-on toy. To stop you must take your foot off the foot pedal.
- Children must be supervised by an adult at all times to be safe.
- Do not activate the foot pedal unless you are seated on the ride-on toy and in a safe, outdoor environment that is suitable for riding your electric ride-on toy.
- Keep both hands on the steering wheel at all times.
- Never allow more than one person to ride the electric ride-on toy at one time and never try to tow anything.
- Do not ride in wet weather.
- Ride only on smooth, flat, dry surfaces such as pavement or level ground without loose debris, such as sand, leaves, rocks or gravel. Water, mud, ice, bumpy, uneven, slick, or rough surfaces could impair traction and contribute to possible loss of control.
- Do not ride on or near hills or steep inclines. Ride only on level ground to avoid tip over.
- Do not ride at night or where there is limited visibility.
- Do not ride indoors or on surfaces that could become damaged such as carpet or flooring.
- Do not ride on streets, around cars, or in foot or vehicle traffic.
- Regularly check the electric ride-on toy and its components. If any parts are broken or worn, do not ride the electric ride-on toy until you have fixed or replaced the broken or worn parts.

 **WARNING:**
RISK OF FIRE.
Do not bypass fuse.
Replace only with 25A fuse

 **WARNING:**
RISK OF FIRE.
Do not bypass fuse.
Replace only with 3A fuse

Parts list

PART NO.	PART NAME	Q'ty (pcs)		REMARKS
1	Ride-on toy body	1		
2	Gear box	2		
3	Driving wheel	2		
4	Front wheel	2		
5	Bushing	2		
6	Ø10 washer	8		
7	Lock nut	4		
8	Axle cap	4		
9	Steering column	1		
10	Steering wheel	1		
11	M5x35 machine screw	1		Mounted on the steering wheel
12	M5 nut	1		Mounted on the steering wheel
13	Motor hood	2		
14	4x12 screw	8		
15	Seat	1		
16	M5x16 machine screw	2		Mounted on the seat
17	Rear axle	1		
18	Wing mirror	2		Left and right
19	Socket wrench	2		
20	Charger	1		
21	Snap ring	1		

Parts diagrams

HINT: Some parts shown are assembled on both sides of ride-on toy.

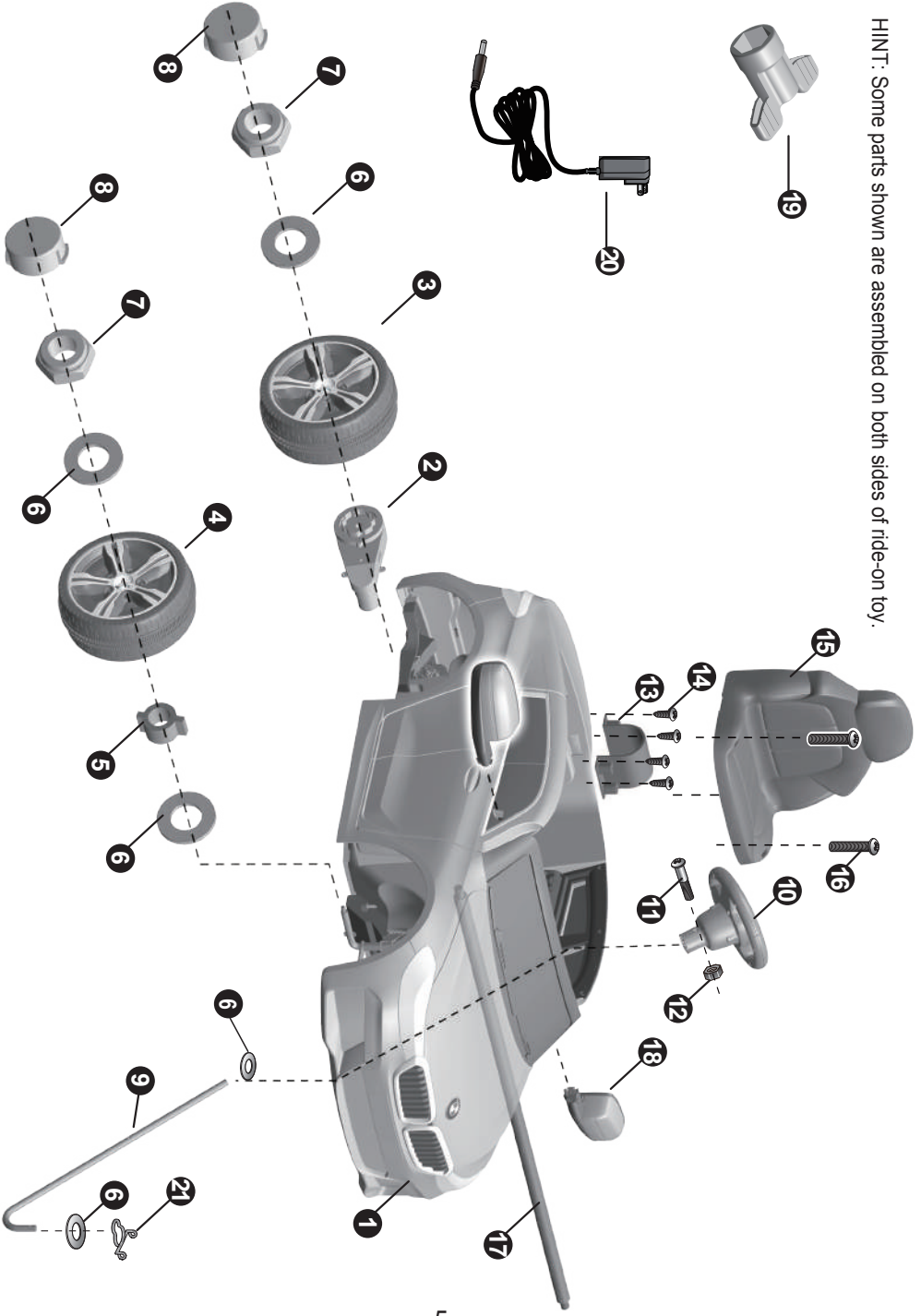

Assembly Steps

NOTE: Remove all packing and items from the display box. Make sure that the power switch is turned "OFF" before assembling the electric ride-on toy.

- Your new ride-on toy requires adult assembly. Please set aside at least 30 minutes for assembly.
- Please identify all parts before assembly and save all packaging material until assembly is complete to ensure that no parts are discarded.

TOOLS REQUIRED:



Phillips Screwdriver
(not included)

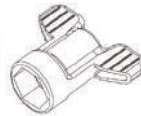

Socket Wrench
(included)

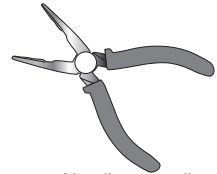

Needle nose pliers
(not included)

! WARNING: Children can be harmed by small parts, sharp edges and sharp points in the ride-on toy's unassembled state, or by electrical items. In the unassembled state, this package contains small parts. Adult assembly is required; children should not handle parts, or help in assembly of the ride-on toy.

! WARNING: Battery can fall out and injure a child if the ride-on toy tips over. Always use battery retainer.

! WARNING: Charging should only be performed by adults.

! WARNING: DO NOT USE NON-ORIGINAL OR NON-RECOMMENDED PRODUCTS WITH YOUR ELECTRIC RIDE-ON TOY.

Altering of the original components or use of non-recommended replacement parts may or may not be compatible with the design and will void the warranty and may cause an unsafe condition resulting in serious injury or death.

Only use the battery specified by the manufacturer.
Only use the charger specified by the manufacturer.

1.

Attach the Rear Axle

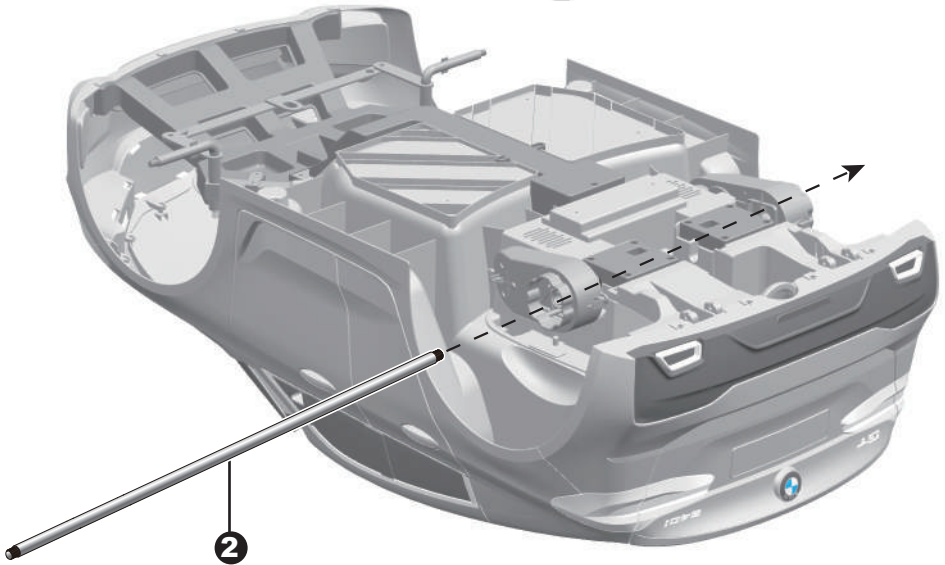
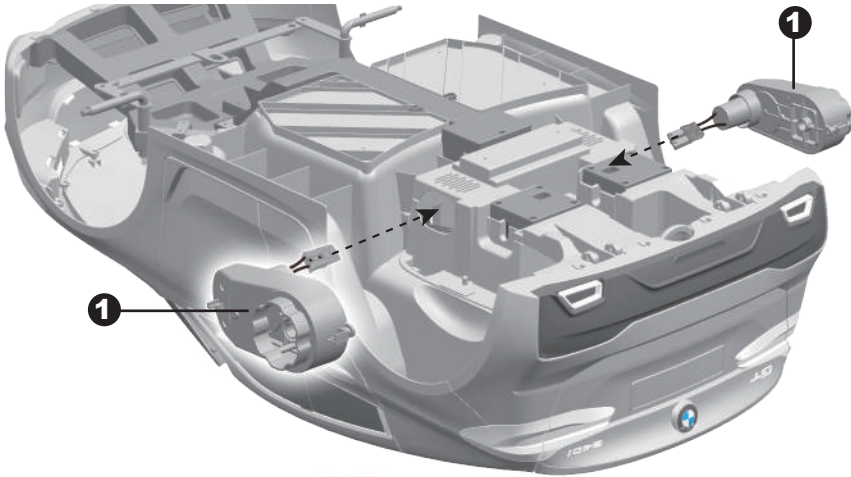

Remove the **rear axle (together with all the parts)** from the ride-on toy body.

1. Slide the **motor** and the **connector** on one gear box through the larger hole on the rear of the ride-on toy body and out where the battery sits.

Repeat for the other gear box.

2. Insert the rear axle through the hole on the gear box, into the hole on the ride-on toy body and out through the hole in the gear box on the other side.

2.

Attach the Driving Wheels

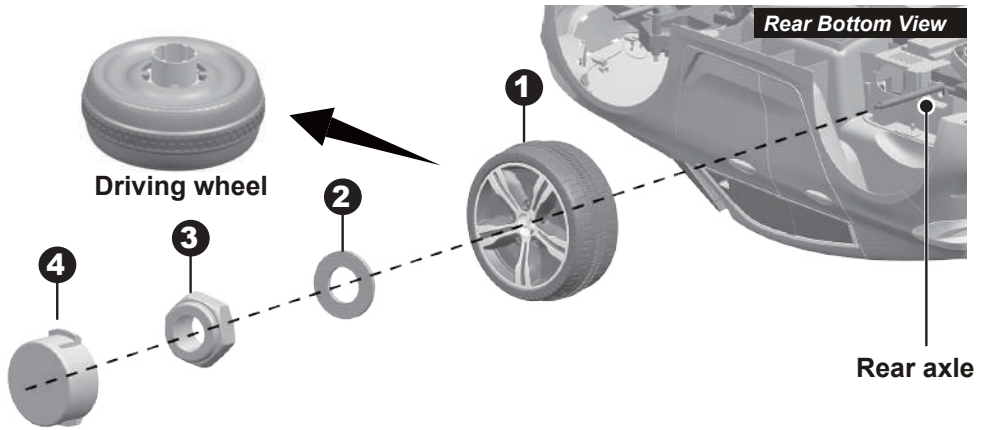

1. Slide one **driving wheel** onto the rear axle, and keep the driving wheel match up with the gear box.
2. Slide the **Ø10 washer** onto the rear axle.
3. Tighten a **lock nut** to the end of the rear axle with a socket wrench.
4. “Snap” the **axle cap** to the wheel.

Repeat the above procedure to assemble the **other driving wheel**.

HINT: An extra socket wrench has been provided to hold the Lock Nut on the other side of the rear axle while tightening the Lock Nut on the other side.

3.

Attach the Front Front Wheels

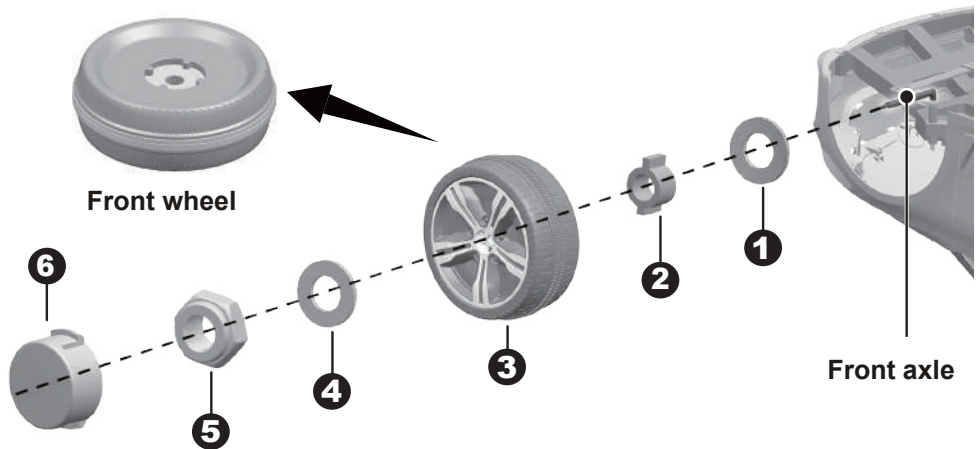

Remove all the parts from the front axle.

1. Slide a **Ø10 washer** onto the front axle.
2. Slide a **bushing** onto the front axle.
3. Slide a **front wheel** onto the front axle. Ensure the bushing matches with the front wheel.
4. Slide a **Ø10 washer** onto the front axle.
5. Tighten a **Lock nut** to the end of the front axle with a socket wrench.
6. “Snap” the **axle cap** to the wheel.

Repeat the above procedure to assemble the other front wheel.

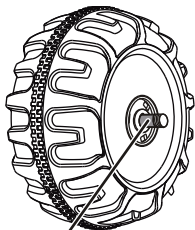

GAP

After assembling any wheel to the axles, please check the gap between the screw thread and the collapsible (refer to below picture), if the gap is too big, please add two or three washers inside the wheel, but after tightening the nut outside the wheel, please turn the wheel by your finger to check if the wheel can run smoothly, this is very important, because if the wheel can run smoothly, it is ok, but if the nut presses the wheel and the wheel can't run smoothly, the motor will be broken easily! Then you need to decrease one or two washers to make sure the wheel can run smoothly!

4.

Attach the Steering Column

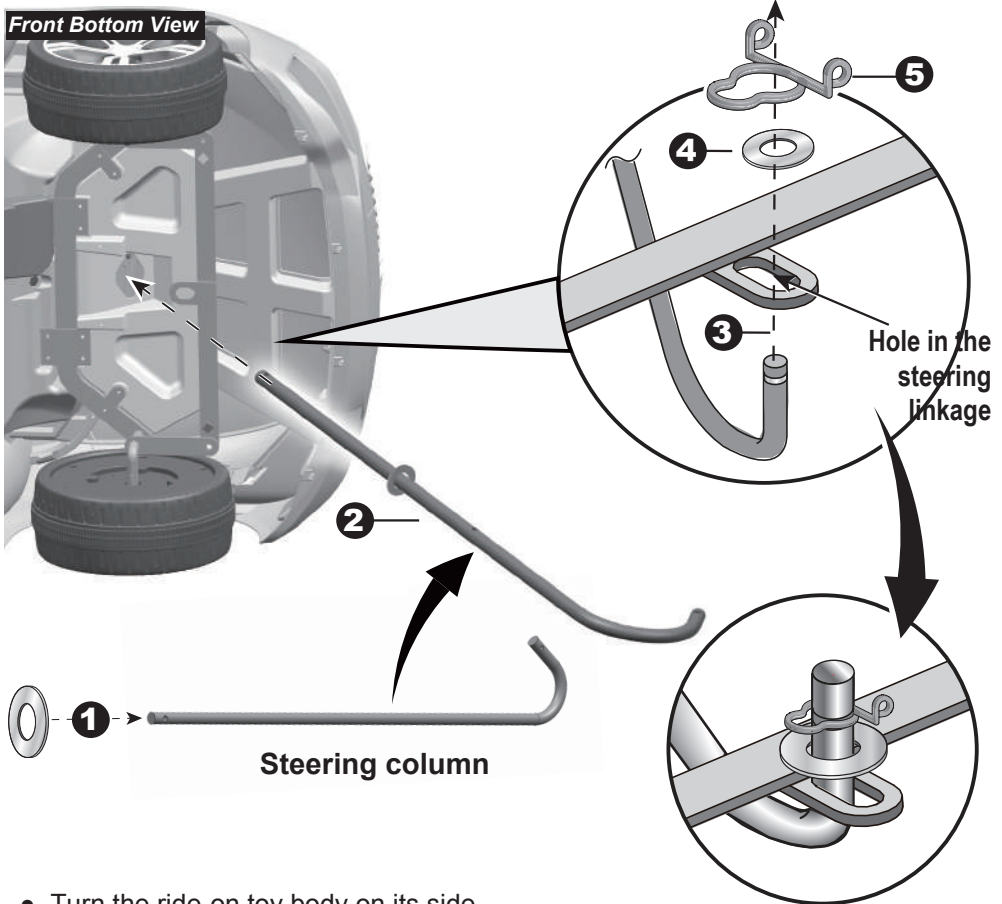

- Turn the ride-on toy body on its side.

1. Slide a $\text{Ø}10$ washer onto the **steering column** from the straight end.
2. Insert the **straight end of steering column** up through the **hole** in the front of ride-on toy body from bottom side, and out through the **hole in the dash**.
3. Insert the **bent end of steering column** through the **hole in the steering linkage**.
4. Fit a $\text{Ø}10$ washer onto the **bent end** of the steering column.
5. Hand squeeze the snap ring and slide it into the groove in the **bent end** of the steering column.

5. Attach the Steering Wheel

Turn the ride-on toy body upright. (HINT: Batteries are not included.)

Adding the Batteries of Steering Wheel

1. Use a screwdriver to remove the screw on the **battery cover** located in the center of the steering wheel.
2. Remove the **battery cover** from the top of the **battery compartment**.
3. Insert 2x1.5 **AA batteries** in their correct polarities.
4. Replace the **battery cover** over the **battery compartment** and fasten with the screw you removed in step one.

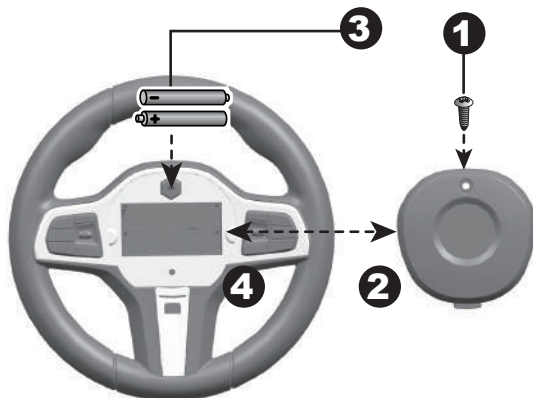

Attach the Steering Wheel

Remove the **M5x35 machine screw** and **M5 nut** from the **steering wheel**.

5. Place the **steering wheel** over the the steering column, protruding from the middle of the **steering wheel base**.
6. Align the holes on each side of **steering wheel** with the holes at the **end of the steering column**.
7. Fasten the **M5 nut** on the opposite end of the **screw** to secure the steering wheel to the steering column.

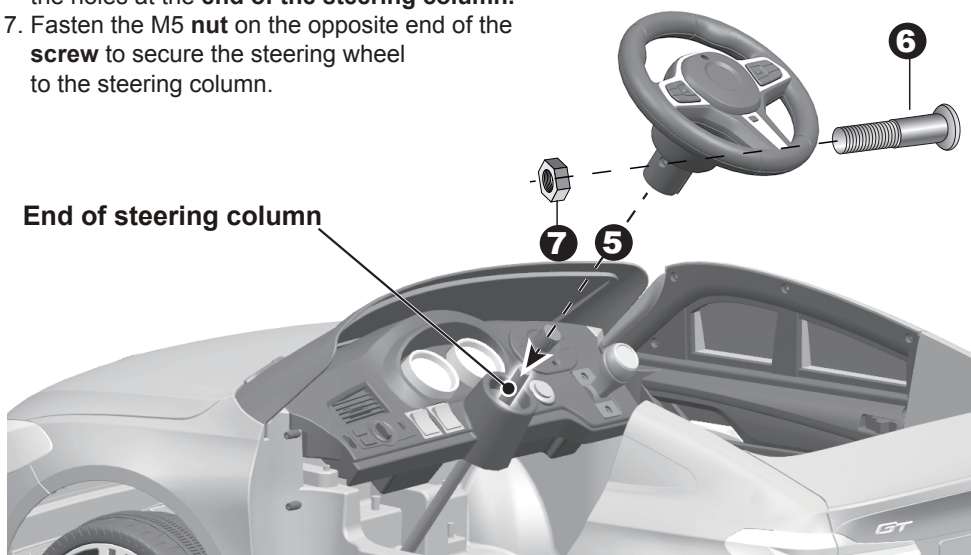



STEERING WHEEL BATTERY SAFETY INFORMATION

Batteries may leak fluids that can cause chemical burn, injury or ruin your product.

To avoid battery leakage:

- Install batteries correctly, observing the polarity (+/-) signs to avoid leakage.
- Do not mix old and new batteries.
- Do not mix batteries of different types: alkaline, standard (carbon-zinc) or rechargeable (NiMH).
- Remove the batteries from the battery compartment when the unit will not be used for an extended period of time.
- Always remove exhausted batteries from the battery compartment.
- Do not dispose of batteries in fire.
- Do not short circuit the supply terminals.
- Replace the batteries when the horn sounds become distorted.
- Non-rechargeable batteries should not be recharged.
- Use only batteries of the same or equivalent type as recommended.
- If rechargeable batteries are used, they should only be charged by an adult.
- Remove rechargeable batteries from the product before charging.
- Battery chargers used with toys must be examined regularly for damage to the cord, plug, enclosure and other parts. In the event that such damage is found, the toy must not be used with the battery charger until the damage has been repaired.

6.

Connect the Power Supply

Rear Top View

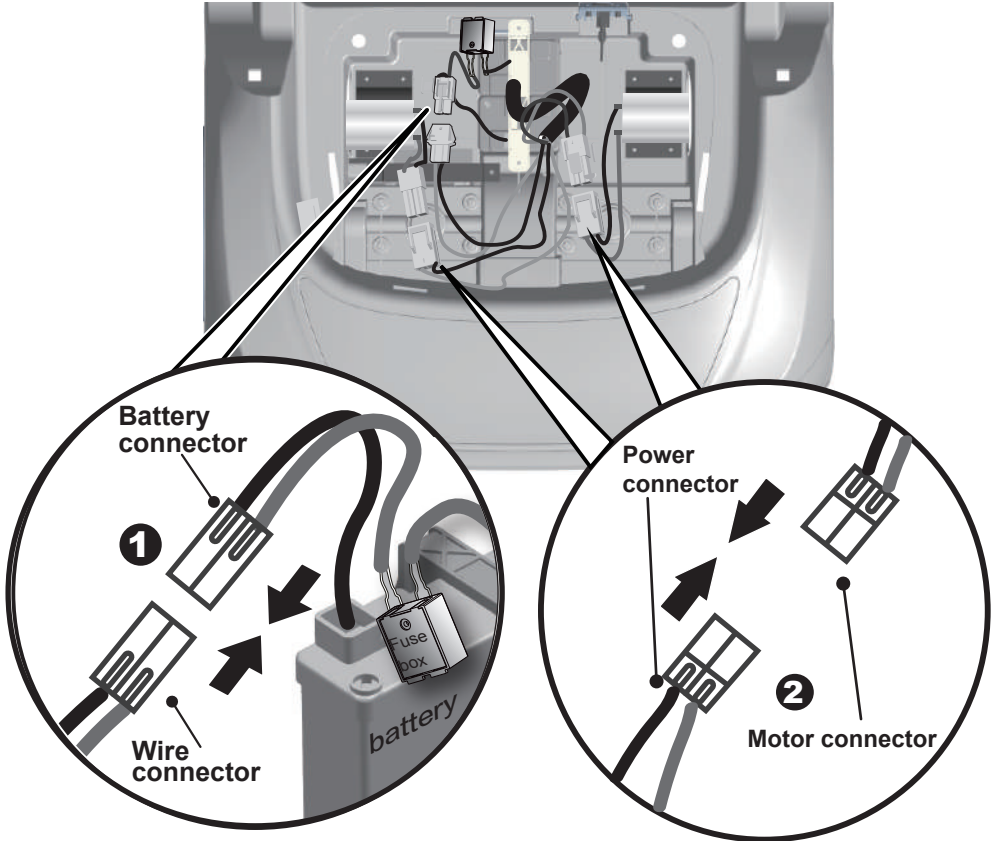

NOTE : The battery is disconnected for shipment to prevent the battery from draining.

1. Plug the **wire connector** into the battery connector.
2. Plug the **power connector** into the **motor connector** on body as shown above. Repeat for the other side.

7.

Attach the Motor Hood(s)

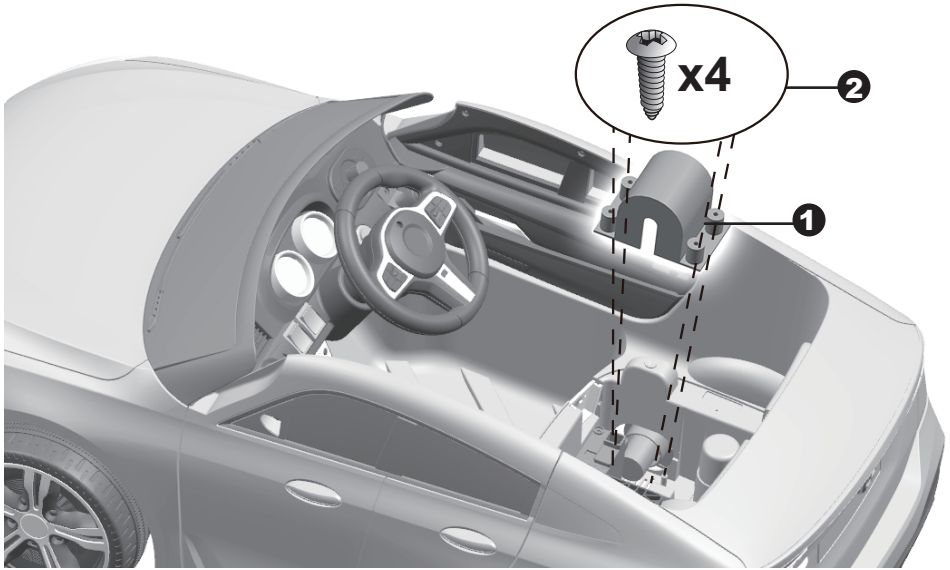

1. Fit the **motor hood** over the motor.
2. Insert four **4x12 screws** and tighten.
Repeat for the other motor hood.

8.

Attach the Seat & Wing Mirrors

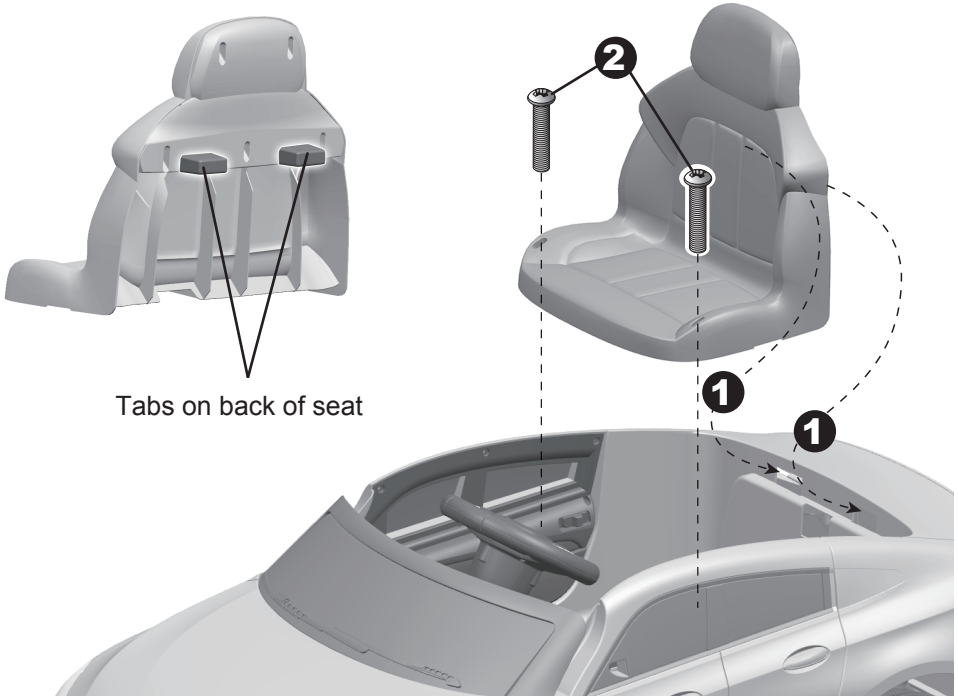

1. Fit the tabs on **back of the seat** into the slots in the rear of the ride-on toy.
2. Insert two M5x16 machine screws (pre-mounted on the seat) through the seat and into the ride-on toy body, and tighten them with a screwdriver.
3. Fit the **wing mirror** into the hole in the door. Repeat for the other side.



9.

Use the Door Lock

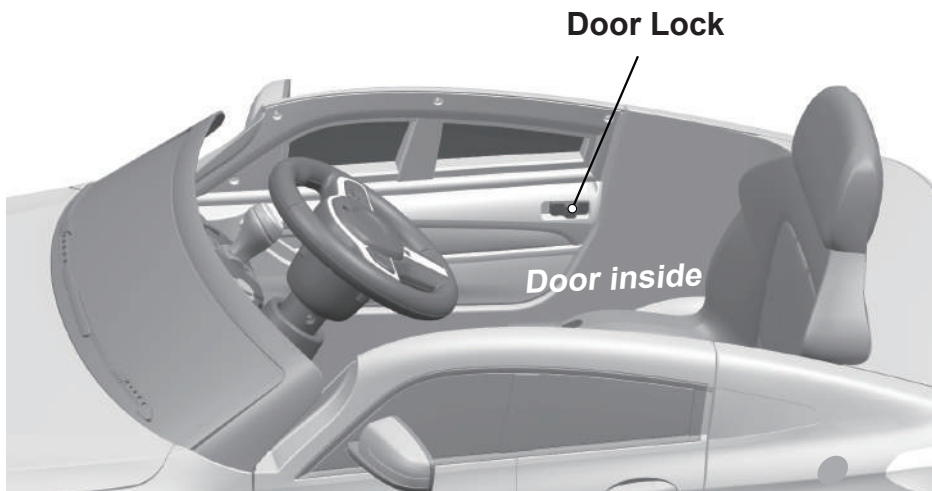

NOTE:

Please close the door and ensure the lock snap into place when riding for safety consideration.

How To Operate Your Ride-On Toy

WARNING!

PREVENT INJURIES AND DEATHS:

- **NEVER LEAVE CHILD UNATTENDED. DIRECT ADULT SUPERVISION IS REQUIRED.** Always keep child in view when child is in ride-on Toy .
- Never use in roadways, near cars, on or near steep inclines or steps, swimming pools or other bodies of water.
- Always wear shoes.
- Always sit on the seat.
- Suitable for age 3~5 years; Maximum user weight is 55 lb (25kg).

Rules for Safe Riding

READ THESE RULES ALOUD TO YOUR CHILD AND THEIR PLAYMATES AND MAKE SURE THEY UNDERSTAND THEM!

- Always wear a helmet when riding.
- Direct adult supervision required.
- Keep children within safe riding areas:
- Never use in roadway, near motor vehicles, on lawn space, on or near steep inclines or steps, swimming pools or other bodies of water;
- Use the toy only on flat surfaces. such as inside your house, garden or playground.
- Never use in the dark. A child could encounter unexpected obstacles and have an accident. Operate the ride-on toy only in the daytime or a well-lit area.
- It is not recommended to drive the ride-on toy on wet surfaces or on lopes of greater than 15 degrees.
- Do not use this ride-on toy outdoors when it is raining or snowing.
- Make sure you come to a complete stop before changing directions from forward to back.
- Please follow the correct weight and age limits allowed to drive this ride-on toy.
- It is prohibited to change the circuit or add other electric parts.
- Inspect wires and connections of the ride-on toy periodically.
- In order to avoid accidents, please ensure the ride-on toy is safe before riding.
- Do not let any child touch the wheels or be near them when the ride-on toy is moving .

How To Operate Your Ride-On Toy

Ensure the power switch has been turned on.

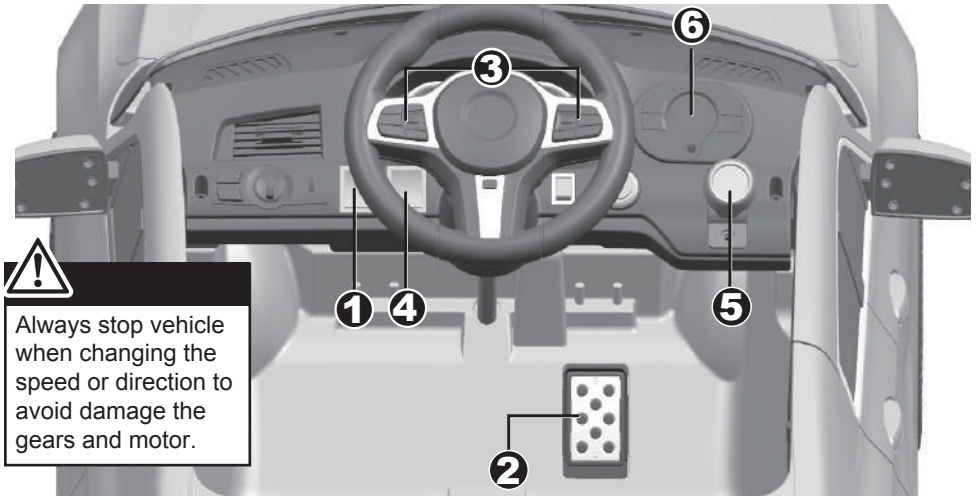

1. **POWER SWITCH:** Turn the ride-on toy on and off.

2. **FOOT PEDAL:**

- To move the ride-on toy, press the foot pedal down.
- To stop, take your foot off the foot pedal.

3. **SOUND BUTTON:** Press for sound playing.

4. **HIGH/LOW SPEED SWITCH** (Located under seat):

Operates the ride-on toy to move forward in high speed and low speed.

5. **FORWARD-REVERSE SHIFT LEVER:** Change the direction that ride-on toy moves forward and reverse.

- To move the ride-on toy forward, shift the lever to top position.
- To move the ride-on toy backward, shift the lever to down position.

6. **AUDIO INPUT JACK:**

Use the audio input cable (included) to connect your MP3 player or other compatible audio device with this ride-on toy to listen to and enjoy music and have fun playing.

- Plug one end of the audio input cable (included) into the audio input jack on the ride-on toy as shown.
- Plug the other end of the audio input cable into the headphone jack on your audio device or MP3 player.
- Adjust your audio device or MP3 player volume to low level and turn the power switch on your ride-on toy to the "ON" position.

- Then adjust the volume to increase or decrease its sound level as desired.

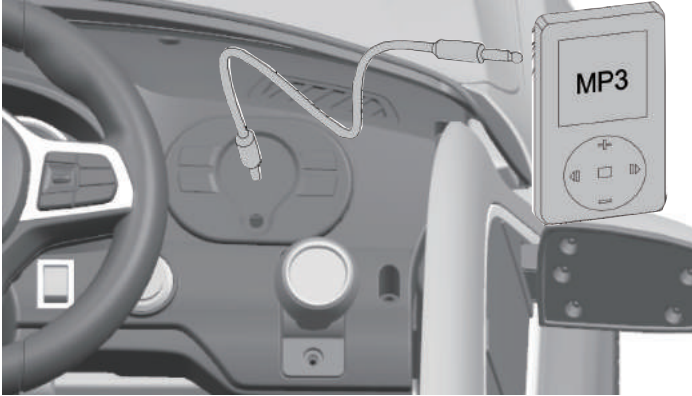

NOTE: MP3 player or audio device not included.

! WARNING: Do not let use of an MP3 player or other audio device interfere with safe riding.

! IMPORTANT

- Always stop ride-on toy when changing the speed or direction to avoid damage the gears and motor.
- **HIGH SPEED:** Make sure your child knows how to steer, how to start and stop the ride-on toy and knows the rules for safe driving.



Charging Your Ride-On Toy

IMPORTANT! Before first time use, charge the battery for at least 18 hours. Charge the battery for at least 12 hours after each use of the ride-on toy. Never charge the battery longer than 30 hours. Overcharging or undercharging the battery may shorten battery life and decrease ride-on toy running time.

PREVENT FIRE

- Never modify the electrical system.
- Alterations could cause a fire resulting in serious injury and could also ruin the electrical system.
- Use of the wrong type battery or charger could cause a fire or explosion, resulting in serious injury.
- Use of non-original components on this ride-on toy could cause overheating, fire or explosion.
- The battery must be handled by adults only.
- The battery is heavy and contains sulfuric acid (electrolyte).
- Dropping the battery could result in serious injury.
- Never allow children to charge the battery.
- Battery charging must be done by adults only. A child could be injured by the electricity involved in charging the battery.
- Never lift or carry the battery by the wires or connector, this can damage the battery and possibly cause a fire resulting in serious injury. Lift and carry the battery by the case only.
- Read the safety instructions on the battery.
- Examine the battery, charger and their connectors for excessive wear or damage each time you charge the battery.
- If damage or excessive wear is detected, do not use the charger or the battery until you have replaced the worn or damaged part.



WARNING: Use the charger in dry locations only.

IMPORTANT NOTE:

- We recommend that you start charging your battery before beginning assembly of your new ride-on toy.
- The battery must be upright while charging.
- The charger is not a toy. Keep away from children.
- Do not short-circuit the battery.
- You do not need to remove the battery from your ride-on toy to recharge it.
- Before charging the battery, examine the battery case for cracks and other damage which may cause sulfuric acid (electrolyte) to leak during the charging process. If damage is detected, do not charge the battery or use it in your ride-on toy. Battery acid is very corrosive and can cause severe damage to surfaces it contacts.
- Use only an original charger (AC 120V 60Hz) with an output of DC 12V (0.5A) to charge your ride-on toy battery.
- **NOTE TO ADULTS:** Regularly examine the charger for damage to the cord, plug, housing or other parts that may result in the risk of fire, electric shock or injury.

- If your battery is old and will not accept a charge, do not leave it in the ride-on toy. Always remove a dead battery from the ride-on toy.
- After the first charge, recharge the battery for at least 12 hours after each use. Never charge the battery longer than 30 hours. Charge the battery after each use, regardless of how long the ride-on toy was used.
- Do not allow the battery to run down completely before charging.
- Charge the battery before storing the ride-on toy.
- Charge the battery at least once per month, even if the ride-on toy has not been used.

NOTE:

- This product has CHARGING PROTECTION: when charging, all the functions will be cut off.
- Recharges after initial charge - At least 12 hours, and never charge the battery longer than 30 hours.
- When the ride-on toy begins to run slowly, recharge the battery.
- After each use or once a month minimum recharge time 12 hours, less than 30 hours at most.

! WARNING: Use the charger in dry locations only.

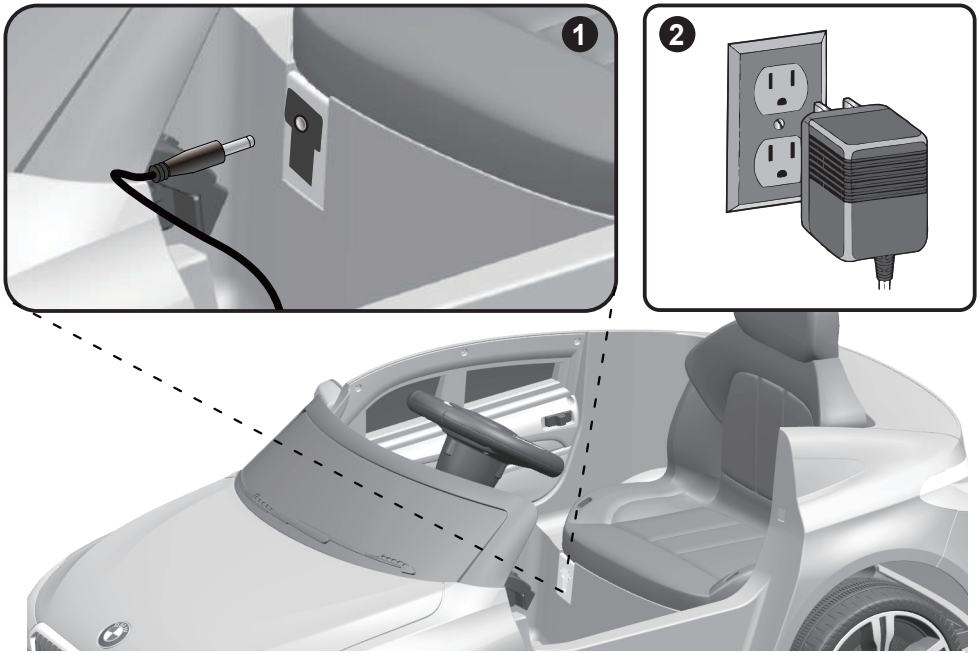

1. Plug the charger port into the input socket (the socket below the seat).
2. Plug the charger plug into a wall outlet. The battery will begin charging.

NOTE: Red LED light indicates battery is charging and a green LED light indicates battery is nearly fully charged. (If the lights on the charger do not light up, check the power to the outlets.)

Troubleshooting Guide

Problem	Possible Cause	Solution
Ride-On Toy does not run	Undercharged battery	<p>Charge the battery. A new battery should have been charged for at least 18 hours before using the ride-on toy for the first time. After first-time use, recharge the battery for at least 12 hours after each use. Never charge the battery longer than 30 hours.</p> <p>Check all connectors. Make sure the battery connector is tightly plugged into the wire connector, and that the charger is plugged into the wall outlet.</p> <p>Make sure that there is power flow to the wall outlet.</p>
	Tripped fuse	<p>The fuse may “trip” and shut down operation of the ride-on toy if the ride-on toy is overloaded or the driving conditions are too severe. Once a fuse has “tripped”, set the power switch to the “OFF” position and do not continuously push on the foot pedal. The fuse will automatically reset itself after approximately 2 minutes and allow the ride-on toy to resume normal operations. To avoid repeated automatic shutdowns, do not overload the ride-on toy by exceeding the 55lb maximum weight capacity or by towing anything behind the ride-on toy. Do not drive up hills or run into fixed objects, which can cause the wheels to stop spinning while power is still being supplied to the motor.</p>
	Electrical switch damage	<p>The electrical switches can become corroded due to exposure to water or moisture, or can jam due to loose dirt, sand or gravel.</p>
	Dead battery	<p>Check all wires and connectors. Make sure the battery connector is tightly plugged into the wire connector and that there are no loose wires around the motor.</p> <p>If your battery is old or if you have not followed Battery Care instructions, your battery may be dead. Replace only with an original 6V4AH x 2 battery. Do not use non-original substitute parts.</p>

Problem	Possible Cause	Solution
Ride-on toy was running but suddenly stopped	Loose wires or connectors	Check all wires and connectors. Make sure the battery connector is tightly plugged into the wire connector, and that there are no loose wires around the motor.
	Tripped fuse	The fuse may “trip” and shut down operation of the ride-on toy if the ride-on toy is overloaded or the driving conditions too severe. Once a fuse has “tripped”, set the power switch to the “OFF” position and do not continuously push on the foot pedal. The fuse will automatically reset itself after approximately 2 minutes and allow the ride-on toy to resume normal operations. To avoid repeated automatic shutdowns, do not overload the ride-on toy by exceeding the 55 lb maximum weight capacity or by towing anything behind the ride-on toy. Do not drive up hills or run into fixed objects, which can cause the wheels to stop spinning while power is still being supplied to the motor.
Short run time (less than 15 minutes per charge)	Undercharged battery	Charge the battery. A new battery should have been charged for at least 18 hours before using the ride-on toy for the first time. After first-time use, recharge the battery for at least 12 hours after each use. Never charge the battery longer than 30 hours. Check all wires and connectors. Make sure the battery connector is tightly plugged into the wire connector, and that the charger is plugged into the wall. Make sure that there is power flow to the wall outlet.
	Overcharged battery	Do not charge the battery longer than 30 hours. If you suspect that your battery is damaged as a result of overcharging, change with one new original 6V4AH x 2 battery. Do not use non-original substitute parts.
	Battery is old and will not accept full charge	Even with proper care, a rechargeable battery does not last forever. Average battery life is 1 to 3 years depending on ride-on toy use and use conditions. Replace only with an original 6V4AH x 2 battery. Do not use non-original substitute parts
	Tripped fuse	The fuse may “trip” and shut down operation of the ride-on toy if the ride-on toy is overloaded or the driving conditions are too severe. Once a fuse has “tripped”, set the power switch to the “OFF” position and do not continuously push on the foot pedal. The fuse will automatically reset itself after approximately 2 minutes and allow the ride-on toy to resume normal operations. To avoid repeated automatic shutdowns, do not overload the ride-on toy by exceeding the 55lb maximum weight capacity or by towing anything behind the ride-on toy. Do not drive up hills or run into fixed objects, which can cause the wheels to stop spinning while power is still being supplied to the motor.

Problem	Possible Cause	Solution
Ride-on toy runs sluggishly	Undercharged battery	Charge the battery. A new battery should have been charged for at least 18 hours before using the ride-on toy for the first time. After first-time use, recharge the battery for at least 12 hours after each use. Never charge the battery longer than 30 hours. Check all connectors. Make sure the battery connector is tightly plugged into the wire connector, and that the charger is plugged into the wall outlet. Make sure that there is power flow to the wall outlet.
	Battery needs charging	Be sure to charge the battery after each use of the ride-on toy.
	Ride-on toy is overloaded	Make sure you do not overload the ride-on toy by allowing more than one rider at one time, exceeding the 55 lb maximum weight capacity, or by towing objects behind the ride-on toy. If the ride-on toy is overloaded, the fuse may “trip”, and automatically shut down operation of the ride-on toy for approximately 2 minutes. Correct the condition that lead to the overload and adjust the driving conditions to prevent repeated automatic shutdowns.
	Driving conditions too stressful	Use only on level ground.
Sometimes the ride-on toy doesn’t run, but other times it does	Loose wire or connector	Check all wires around the motors and all connectors to make sure they are tight.
When th foot pedal is pressed, the ride-on toy won’t run without a push		Check all wires around the motors and all connectors to make sure they are tight.
The battery’s safety fuse constantly “trips”, but the ride-on toy is not overloaded and the driving conditions are not severe	Damaged battery	Replace with new battery. Replace only with an original 6V4AH x 2 battery. Do not use non-original substitute parts.

Problem	Possible Cause	Solution
Charger gets warm during use	It is normal for some chargers to get warm during use and is not reason for concern	No action required.
	Some chargers do not get warm during use	If your charger does not get warm during use, it does not mean that it is not working properly.
Battery makes a sizzling or gurgling noise when charging	It is normal for some batteries to make noise and swell slightly while charging and is not reason for concern	No action required.
		If your battery does not make noise or swell slightly while charging, it does not mean that it is not working properly.

Maintaining Your Ride-On Toy

Occasionally use a lightweight oil to lubricate moving parts such as wheels and the steering linkages.

Park the ride-on toy indoors or cover it with a tarp to protect it from wet weather.

Keep the ride-on toy away from sources of heat, such as stoves and heaters. Plastic parts may melt.

ADULTS ONLY: Recharge the battery after each use. Recharge the battery at least once a month when the ride-on toy is not being used.

DO NOT wash the ride-on toy with a hose. **DO NOT** wash the ride-on toy with soap and water.

DO NOT drive the ride-on toy in rainy or snowy weather. Water will damage the motor, electrical system, and battery.

DO NOT store the ride-on toy, outside in the rain or exposed to the elements. The ride-on toy should be stored inside or covered to protect it from exposure to the elements.

Clean the ride-on toy with a soft, dry cloth. To restore shine to plastic parts, use a non wax furniture polish. **DO NOT** use car wax. **DO NOT** use abrasive cleaners, or cleaners that contain ammonia or isopropyl alcohol.

DO NOT drive the ride-on toy in loose dirt, sand or fine gravel, which could damage moving parts, motors or the electric system.



WARNING: Charge the battery before storing your ride-on toy, otherwise the battery will be damaged.

ABOUT FUSES

Your ride-on toy is equipped with a safety fuse. The fuse is a self-resetting safety device which automatically “trips” and shuts down operation of the ride-on toy if the ride-on toy is overloaded or the operating conditions are too severe. Once a fuse has “tripped,” **set the power switch to the “OFF” position and do not continuously push on foot pedal.** The fuse will automatically reset itself after approximately 2 minutes and allow the ride-on toy to resume normal operations. To avoid repeated automatic shut-downs, do not overload the ride-on toy by exceeding the 55lb (25kg) maximum weight capacity or by towing anything behind the ride-on toy. Avoid severe driving conditions, such as driving up slopes or running into fixed objects, which can cause the wheels to stop spinning while power is still being supplied to the motor.

Battery Care And Disposal

Do not store the battery in temperatures above 75° F (23.5° C) or below 32° F (0° C).



THIS PRODUCT CONTAINS SEALED LEAD ACID BATTERIES WHICH MUST BE RECYCLED IN ACCORDANCE TO YOUR LOCAL AND STATE LAWS. PLEASE CAREFULLY READ AND UNDERSTAND THE FOLLOWING DISPOSAL INSTRUCTIONS:

DISPOSAL : This product contains sealed lead acid batteries which must be disposed of or recycled in an environmentally safe manner. Do not dispose of the batteries in your household trash. Do not dispose of the batteries in a fire, as the battery may explode or leak. The incineration, disposal in landfill and/or placing sealed lead acid batteries with household trash is prohibited by law in most areas. Return exhausted batteries to a state or federal approved lead acid battery recycler or check with your local retailer of vehicle batteries. If you live in Florida, Minnesota or various other states, it is prohibited by law to throw away lead-acid batteries in the municipal waste stream. Check local laws for proper handling and recycling of lead-acid batteries.

WARNING:

- Do not mix old and new batteries. Do not mix alkaline, standard (carbon-zinc), or rechargeable (nickel-cadmium) batteries.
- If a battery leak develops, avoid contact with the leaking acid and place the battery in a plastic bag. See instructions above for proper disposal. If acid comes into contact with skin or eyes, flush with cool water for at least 15 minutes and contact a physician.
- If acid is internally ingested, give water, milk of magnesia or egg whites immediately. Never give emetics or induce vomiting. Call a physician.

CARE

- Leaving the battery in a discharged condition will ruin it.
- Always remove an exhausted battery from the ride-on toy. Battery leakage and corrosion can damage the ride-on toy.
- Do not store the battery in temperatures above 75° F (23.5° C) or below 32° F (0° C).
- Use only a 6V4AH x2 battery. Remember to charge the new battery for at least 18 hours before first use.
- Prevent the battery from moving freely inside the battery compartment. Always use the battery retainer to secure the battery in the battery compartment.
- Examine the battery, charger and their connectors for excessive wear or damage each time you charge the battery. If damage is detected, do not use the charger or the battery until you have replaced the worn or damaged part.

